



Lingshan Steel Structure Co., Ltd.

Tel: 0086-532-83957826 Fax: 0086-532-83957822

Web: <http://www.lstianjun.com/en/> E-mail: sales@lstianjun.com



Lingshan Steel Structure Co., Ltd
Tianjun Steel Structure Engineering Co., Ltd

Steel Structure Building Introduction



Lingshan Steel Structure Co., Ltd.

Tel: 0086-532-83957826 Fax: 0086-532-83957822

Web: <http://www.lstianjun.com/en/> E-mail: sales@lstianjun.com

Dear Sir or Madam,

Thanks for checking our steel structure introduction.

Steel structure is a new steel construction system. The main steel frame is made of hot rolled or welded H section steel; roof and wall purlin use C or Z section steel; roof and wall cladding material is sandwich panel or color steel tile. Then, adding the windows, doors, roof light transfer zone and ventilation, the construction system will be finished.

This document will introduce the building system to you in detail but easy to understand.

If you have any question or commend, welcome to contact us. And your advice will be appreciated very much too.

Thank you again.

Sincerely,

Lingshan Steel Structure Co., Ltd
Tianjun Steel Structure Engineering Co., Ltd





Content

- Part I Main Structure System
- Part II Sub-structure System
- Part III Mezzanine and Bridge Crane
- Part IV Roof System
- Part V Wall System
- Part VI Fittings and Additional Requests

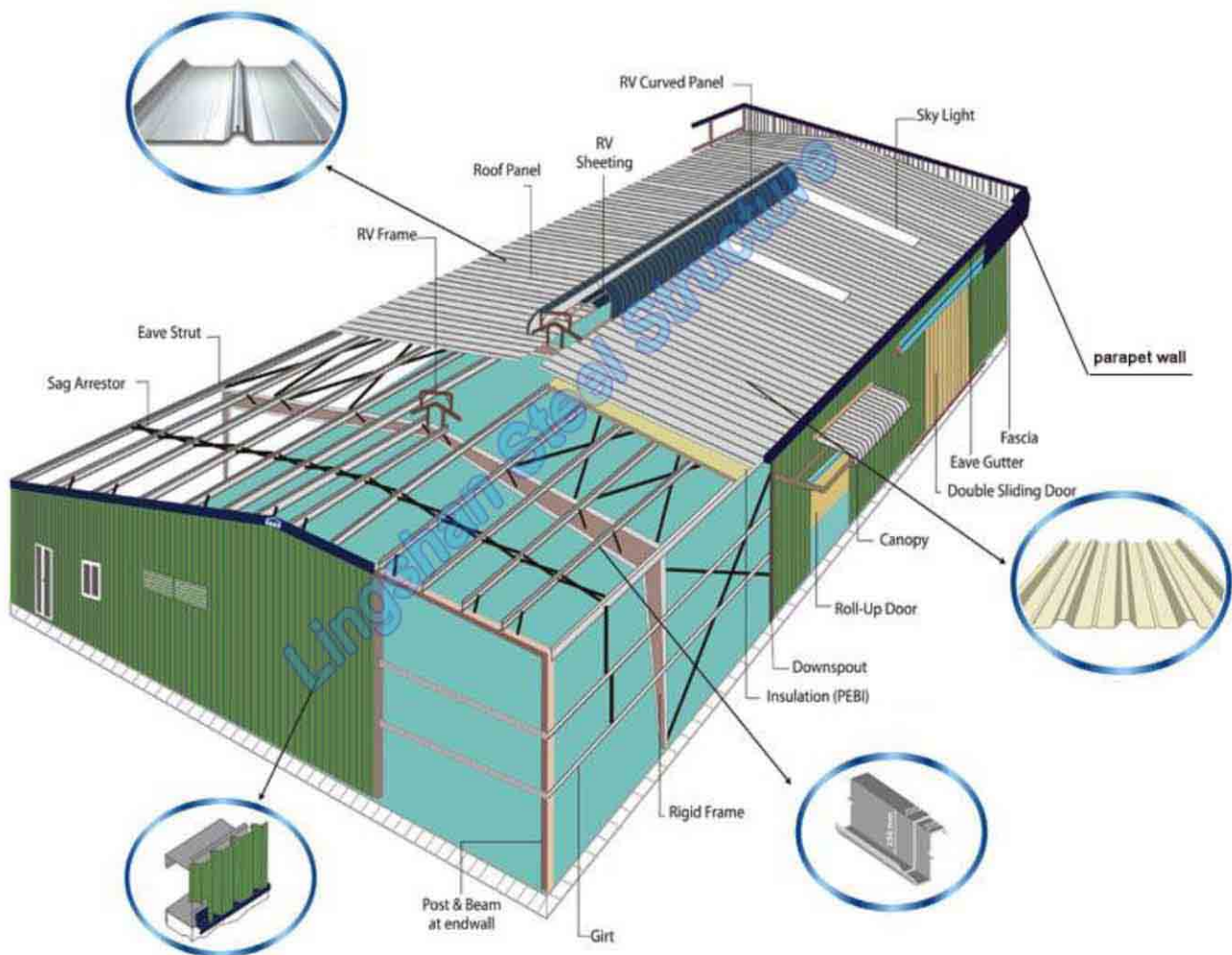



Lingshan Steel Structure Co., Ltd.

Tel: 0086-532-83957826 Fax: 0086-532-83957822

Web: <http://www.lstianjun.com/en/> E-mail: sales@lstianjun.com

Part I Main Structure System

Main steel structure includes steel beams and columns. Both of them made of section steel, usually, H section steel (also called "I" section steel).

The surface treatment could be galvanizing or painting. They are loaded in containers separated, then joint together at the building site with high strength bolts.





Lingshan Steel Structure Co., Ltd.

Tel: 0086-532-83957826 Fax: 0086-532-83957822

Web: <http://www.lstianjun.com/en/> E-mail: sales@lstianjun.com

Part II Sub-structure System

Sub-structure system includes roof purlin, wall purlin, bracing, tie bar and knee brace.

The surface treatment could be galvanizing or painting. They are loaded in containers separated, then joint together at the building site with general bolts.

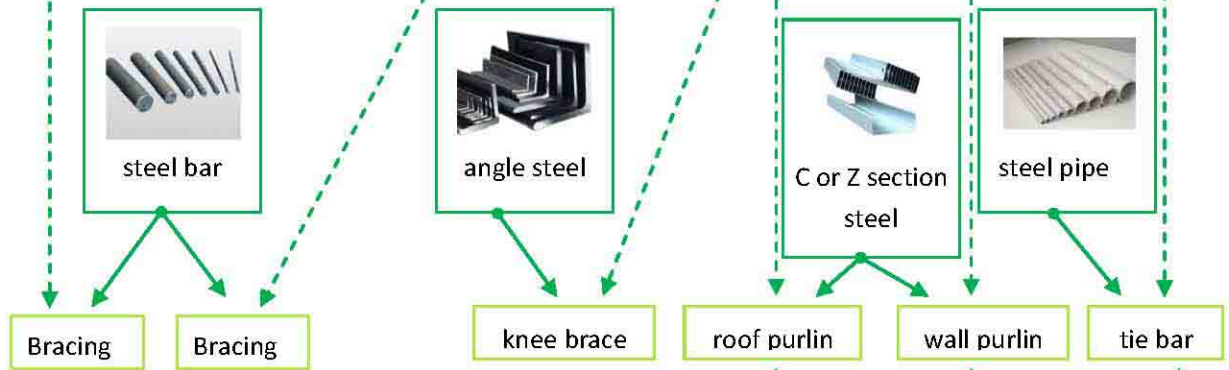



Part III Mezzanine and Bridge Crane (alternative)

The steel structure could be designed for multi-floors, according to the requests from clients, such as office building, hotel building and so on. Then the steel structure building will have mezzanine floors. The up floors will be designed according to the purpose and load ability. Usually, the mezzanine floor will be made of galvanized steel support board then filled with reinforced concrete.

And some steel structure need bridge crane, especially for factory building or warehouse building. The requests will be satisfied too.

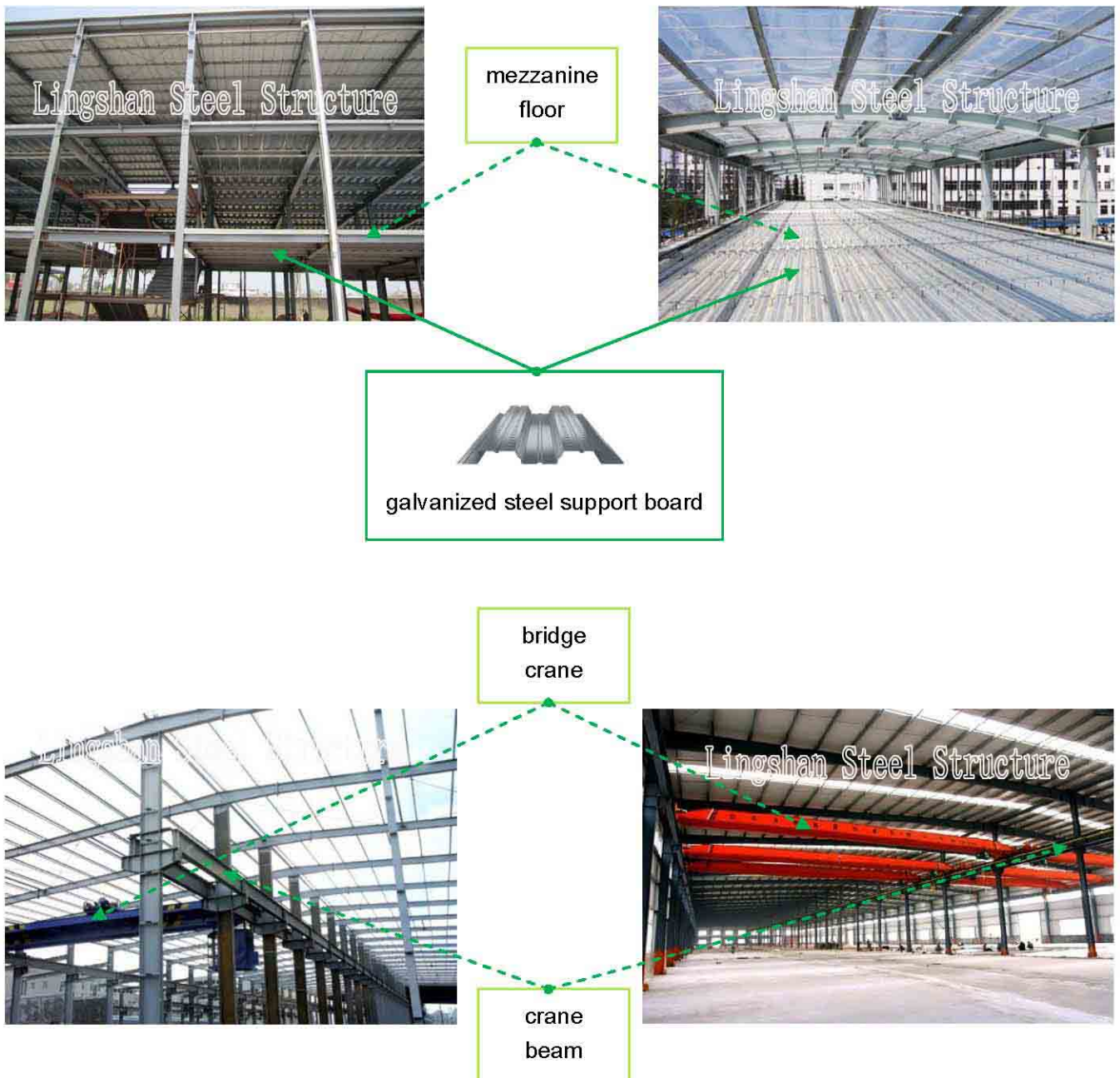



Part IV Roof System

Roof system includes roof cladding panel, air exchange equipment and day light system.

A. Roof cladding panel:

- Galvanized color steel tile
- EPS sandwich panel
- Rock wool sandwich panel
- Fiber glass sandwich panel
- PU/PIR sandwich panel

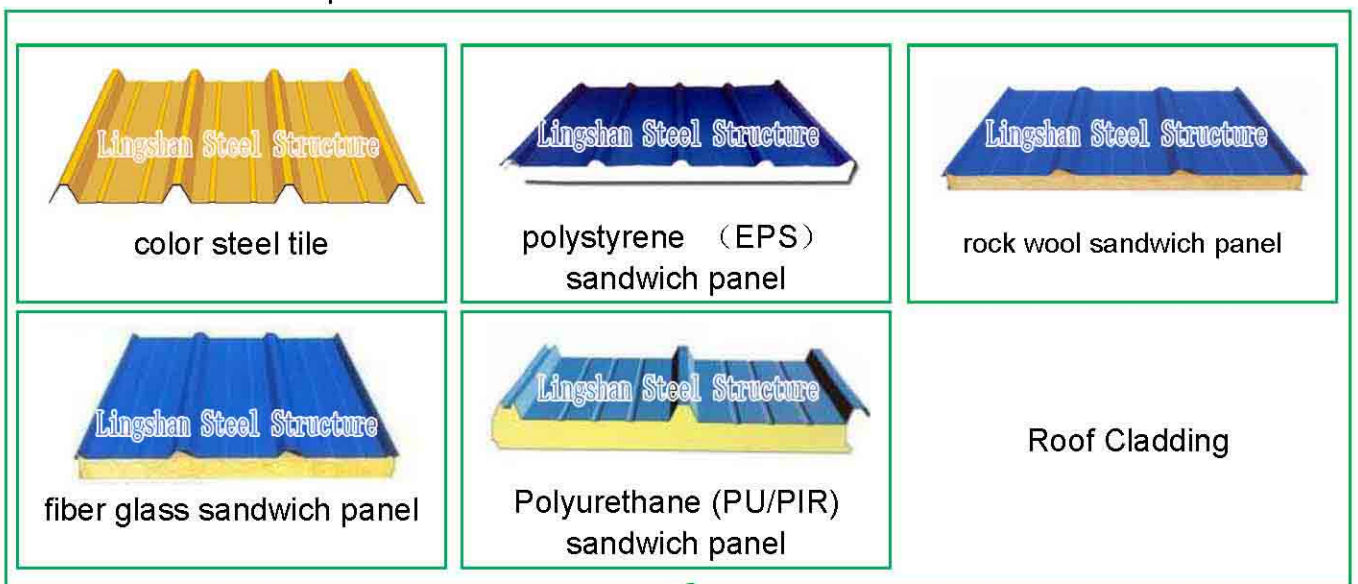



Lingshan Steel Structure Co., Ltd.

Tel: 0086-532-83957826 Fax: 0086-532-83957822

Web: <http://www.lstianjun.com/en/> E-mail: sales@lstianjun.com

B. Air exchange equipment (alternative):

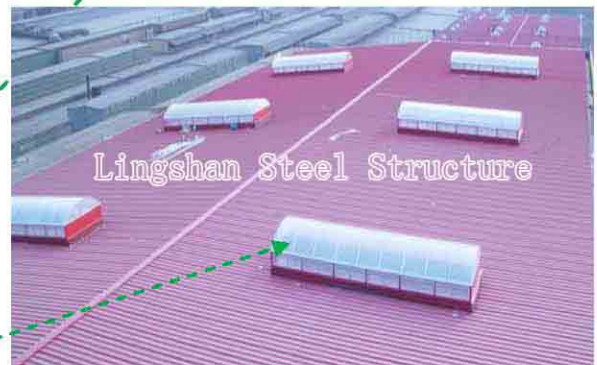

C. Day lighting system (alternative)





Part V Wall System

Wall system includes brick wall, cladding panel, windows, doors, gutter and light transfer zone.

A. Wall cladding panel:

Galvanized color steel tile
EPS sandwich panel
Rock wool sandwich panel
Fiber glass sandwich panel
PU/PIR sandwich panel



color steel tile



rock wool sandwich panel



polystyrene (EPS) sandwich panel

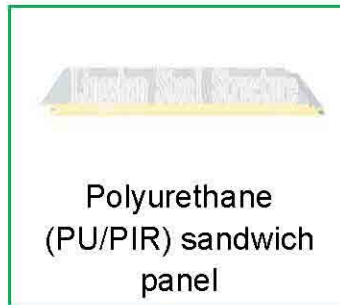

Polyurethane (PU/PIR) sandwich panel



fiber glass sandwich panel

B. Window

Belt window

Unit window

C. Brick wall



D. Door

Rolling up (shutter) door

sliding door

walking door





Lingshan Steel Structure Co., Ltd.

Tel: 0086-532-83957826

Fax: 0086-532-83957822

Web: <http://www.lstianjun.com/en/>

E-mail: sales@lstianjun.com

E. wall light transfer cladding (alternative)



F. Parapet wall (alternative)



F. Gutter (alternative)

Built-in gutter

Plug-in (hanging) gutter

downspout





Part VI Fittings and Additional Requests

A. Fittings

1. Ordinary bolt:
M12, M16, M20 etc



2. High strength bolt:
M20, M24 etc



3. Anchor bolt:
M24, M30, M36 etc



4. Chemical bolt:
M20, M24, M30,
M33, etc



5. Self-tapping screw:
M5.5x25, M5.5x45
M5.5x75, M5.5x100
M5.5x125, etc



6. Edge cover:



B. Additional requests

Additional requests included all the requests from clients. The building could be customized absolutely. For example:

- some building need reinforcement bolt,
- some building have solar panel on the roof,
- some building need galvanization for best anti-rust,
- some building is made by glass and steel frame.
- some building need good fire proof ability
-
-

All the requests will be studied seriously.





Lingshan Steel Structure Co., Ltd.

Tel: 0086-532-83957826 Fax: 0086-532-83957822

Web: <http://www.lstianjun.com/en/> E-mail: sales@lstianjun.com

Dear Sir/Madam,

The introduction for steel structure building finished, thank you for your time and patient. Wish the upwards introduction is helpful for you to understand our light steel structure building system. And welcome to contact with us for any requests.

Best wishes,

Sincerely,

Lingshan Steel Structure Co., Ltd
Tianjun Steel Structure Engineering Co., Ltd

